

# ANG HD15 for KBL 4-15

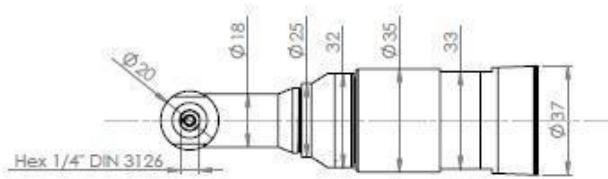

Num	Description	Code
01	Flange motor	251142
02	Flange head	234549
03	90° Angle head	234521/1

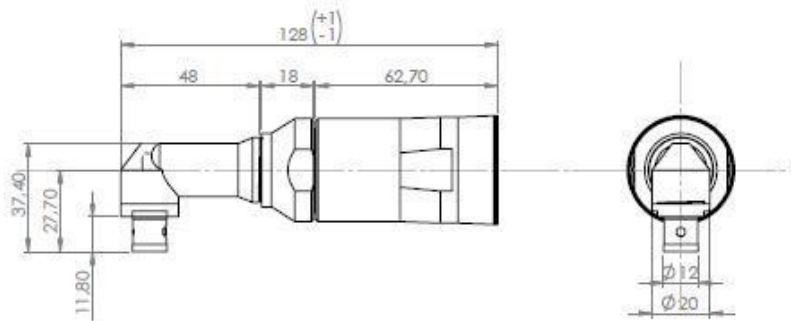
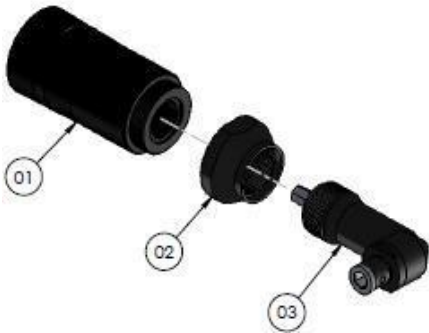

## Instructions:

- Assemble parts # 01,02 and 03. Do not fix them.
- Remove the stop ring (see the picture below):



- Unscrew and remove the torque adjusting nut:



- Unscrew and remove the locking nut (pay attention on the left thread) :



- reassemble the clutch nut and the stop ring. Then tighten this assembly on the screwdriver (fix part #01 to the clutch ) using a 33 wrench. And match to the male 1/4" thread of the angle head:



- Fix part #02 counter clockwise, while holding the screwdriver and part #03 (as in Picture 2), use a 32 wrench.



**Kolver recommend using a glue/threadlocker on the ends to prevent the head from loosening.**